

# ***Dri-Scope Aid® Cabinet***

## **Convert your existing scope cabinet into an automatic scope drying system**

Drying the endoscopes after every reprocessing cycle, both between patient procedures and before storage, is a requisite practice crucial to the prevention of bacterial transmission and nosocomial infections as cleaning and HLD (Kovaleva et al., 2013; Muscarella, 2006).

- **Constant Flow**
- **Consistent Pressure**
- **Repeatable Results**
- **Hang Time Monitoring - Visually Displayed**

The Dri-Scope Aid® Cabinet supplies HEPA-filtered air to all internal channels to aid in drying endoscopes with an automated drying cycle for improved turn-around time, and a continuous venting cycle for overnight storage. The Dri-Scope Aid® Cabinet converts your scope cabinet into a complete drying system.

## **Features & Benefits**

- Significantly improves drying of internal channels
- HEPA filter offers a 99.97% retention rate of particles that have a size > 0.3µm
- Provides constant air delivery through all internal endoscope channels
- Short drying cycle for quick turn-around time
- Continuous venting cycle for overnight storage
- Automatic high-pressure shutoff
- Fulfills forced air recommendations
- Self-adjusting high-pressure regulation

## **Ease of operation**

- Hands-free operation
- Visual display of purging times
- Fits most existing scope cabinets
- Simple to attach individual scope connectors
- Works with major endoscope brands
- Filter replacement indicator light
- Dries 1-16 endoscopes
- Visually displayed
  - Active Drying
  - Cycle Complete/Scope Ready
  - Hang Time Monitoring

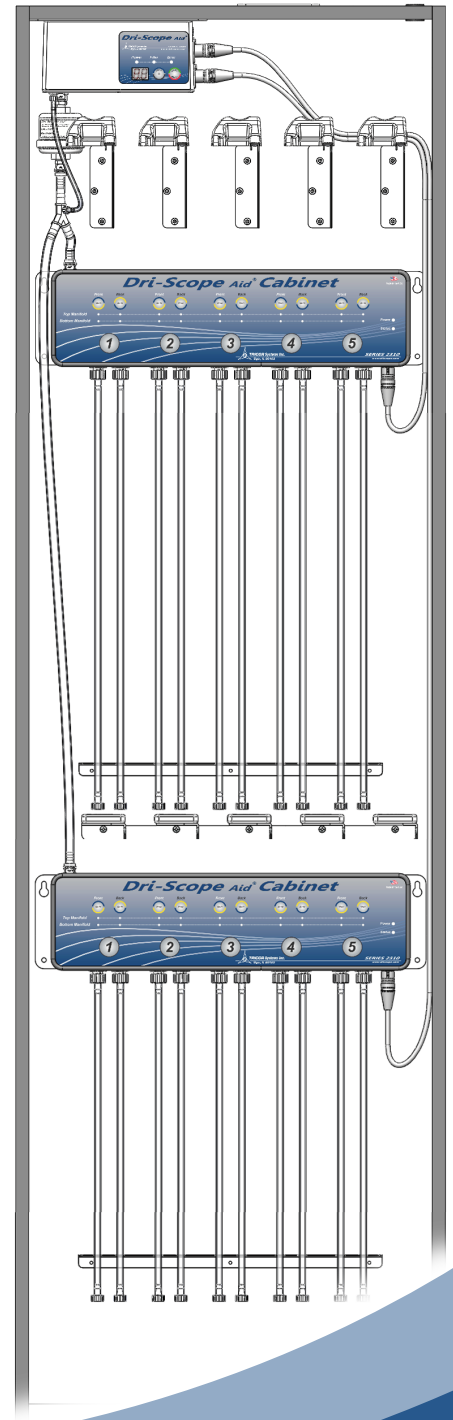

**Made in the USA**

[www.driscopescope.com](http://www.driscopescope.com)  
847-742-5542

# Modernize your endoscope cabinet with a

## *Dri-Scope Aid<sup>®</sup> Cabinet*

drying system

### Specifications

Typical DSAC System (1 pump/supply; 2 manifolds) 12 VDC; 5.3 Amps; 64 Watts

#### 1840 Series Wall Pump

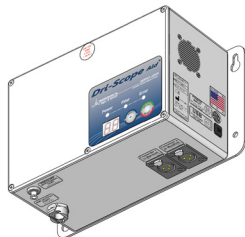

**Unit Size:**  
5.75 H x 10.24 W x 4.23 D (inches)  
14.6 H x 26.0 W x 10.7 D (cm)

**Unit Weight:** 6.5 lbs (2.9 kg)

**Power (max):** 12 VDC; 4.5 A; 54 W

#### 1840 Series Ceiling Pump

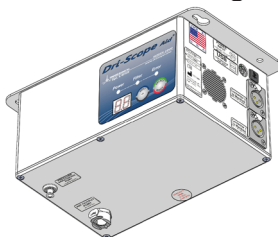

**Unit Size:**  
4.23 H x 10.24 W x 5.75 D (inches)  
10.7 H x 26.0 W x 14.6 D (cm)

**Unit Weight:** 6.5 lbs (2.9 kg)

**Power (max):** 12 VDC; 4.5 A; 54 Watts

#### 23 Series Manifold

(10 port system shown)

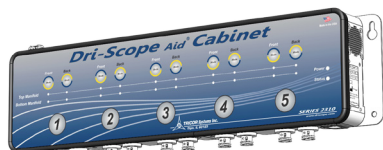

Available in 5 and 10 port configurations

**Unit Size:**  
6.25 H x 23 W x 2.2 D (inches)  
15.9 H x 58.4 W x 5.6 D (cm)

**Unit Weight:** 7 lbs (3.2 kg)

**Power (max):** 12 VDC; 4 A; 4.8 W/ea.

#### 33 Series Manifold

(16 port system shown)



Available in 8 and 16 port configurations

**Unit Size:**  
6.25 H x 33 W x 2.2 D (inches)  
15.9 H x 83.8 W x 5.6 D (cm)

**Unit Weight:** 11 lbs (5.0 kg)

**Power (max):** 12 VDC; 4 A; 4.8 W/ea.

#### Power Supply:

Input: 90 to 250 VAC; 50-60 Hz

Output (max): 12 VDC; 7.5 Amps; 90 Watts

Meets Medical Safety Standard 60601-1 4th edition, UL Recognized, CE Marked

### Medical/Instrument Air Units

#### 1840 Series Wall Supply

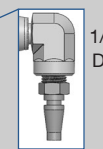
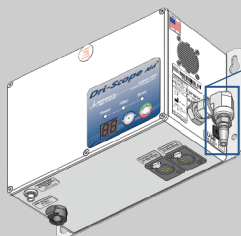

360° Swivel

1/4" Schrader Quick  
Disconnect Medical  
Air Input  
(75 PSI Max)

**Unit Size:**  
5.75 H x 10.24 W x 4.23 D (inches)  
14.6 H x 26.0 W x 10.7 D (cm)

**Unit Weight:** 4.9 lbs (2.2 kg)

**Power (max):** 12 VDC; 1.3 A; 15.6 W

#### 1840 Series Ceiling Supply

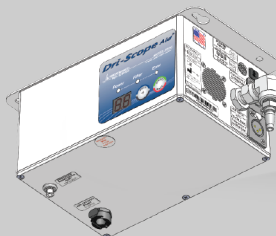

**Unit Size:**  
4.23 H x 10.24 W x 5.75 D (inches)  
10.7 H x 26.0 W x 14.6 D (cm)

**Unit Weight:** 4.9 lbs (2.2 kg)

**Power (max):** 12 VDC; 1.3 A; 15.6 Watts



[www.driscopes.com](http://www.driscopes.com)  
847-742-5542